

WARRANTY AND RETURNS

Your Vitev FLO comes with a 3-year limited warranty for parts and labor (filters excluded) under normal use.

Should there be a warranty issue, just let us know and we'll take care of it.

Activate your warranty via:
phone - 1.855.456.9220
web - www.vitev.com/activate-warranty

All systems purchased directly from www.vitev.com come with a 30-day risk free trial which starts when the system arrives at your home.

If you choose to return your system, you will be responsible for the return shipping costs. We are not responsible for damages to units while in transit for return.

Please hold on to the packaging and accessories during the trial period as returns must be received in "as new" condition.

If you purchased your system from a retailer (anywhere other than www.vitev.com), please refer to their return policy and coordinate with the vendor.

For more information please visit:
www.vitev.com

Feel Younger



© 2012 Vitev LLC. All rights reserved.



FLO

USER GUIDE



INSTALLATION

- 1 Disconnect the aerator from your faucet



- 2 Replace with the included diverter valve*.
*You may need to use one of the included adapters to get the correct fit.



- 3 Run the tubing along and behind the faucet, then connect the elbow adapter to the back of the FLO.

Note: Push tubing completely in.



- 4 Insert the drinking spout into the stem on the top and swivel to the desired location

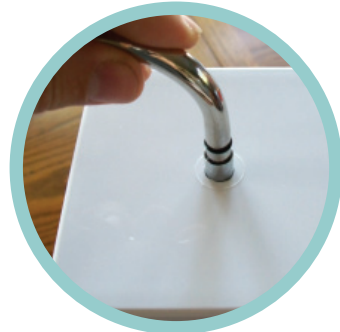

- 5 Turn on the faucet and pull the knob on the diverter valve to send the water to the FLO



- 6 Let the water run for a few minutes until its clear, then stop and let it rest.

Wait a few minutes and run again for 10-15 seconds.

- 7 Fill a glass and ensure its clear. Take a sip.

If anything tastes off or "fishy" run it a little longer to flush the residual carbon.

TIPTOE INTO THE WATER

The best way to incorporate Vitev water is to ease into it. Unless you've been consuming a lot of alkaline water previously, we suggest giving yourself a few days to adjust. It's very common to develop a craving as your cells wake up to true hydration; we just don't want you to overdo it.

So start with a couple glasses through the first day, especially if you don't normally drink much water. Gradually increase until you are at least drinking ½ of your weight a day in ounces. So if you're 150 pounds, shoot for 75 ounces. If you work out, or live in a dry climate, add a little extra.

Vitev water should be used for any drinking* or cooking application. Soups, teas, nutritional shakes, coffee, homebrews, etc are all better when you use better water.

When used correctly, the benefits of Vitev water are wide ranging. Some notice differences very quickly, while others take some time; we're all unique. Whatever you feel, we'd love to hear from you.

*The only exception is medication. Take pharmaceuticals with tap or bottled water so as not to affect the normal delivery process.

FREQUENTLY ASKED QUESTIONS

What's the best way to test the water?

pH testing (aka reagent) drops are the easiest and most cost effective. A couple drops into a sample of water will immediately turn the water a color representing a specific pH level. DO NOT USE STRIPS as they do not perform well with alkaline water.

Can I give this water to children?

Absolutely...in fact, watch how kids are drawn to the water. Ask them how they like it.

How long will the water stay "good"?

Naturally created alkaline water is very stable. It's always best to drink it as fresh as possible, but you'll also find a sustained shelf life. Filling a thermos or bottle and taking it to work, the gym or a couple bottles for the trip out of town is highly encouraged.

Is it OK to heat (or chill) the water?

Yes. There will be some minor change in pH, but that is more due to extended contact with the air than the temperature changes.

When do I know when to change the filter?

With average use (about 2 gallons a day), filters will last 6 months. But there are a lot of differences in source waters, so there will be variations. You'll notice very quickly that Vitev water goes down easier than tap or bottled. These characteristics will go away as the filter is used up as will the pH level which you can check with pH testing drops. Lastly, the filter will stop eliminating pollutants in the water and you'll notice flavors return that were not there will the filter was fully functioning.

HOW TO CHANGE THE FILTER

- 1 Remove the drinking spout

- 2 Push down on the stem and pull up on the case

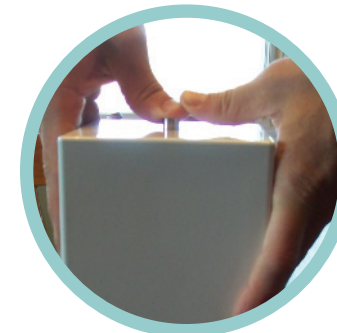

- 3 Remove the filter cover by twisting counterclockwise



- 4 Remove and dispose of the filter.

Replace with new filter and reassemble.



- 5 Flush like you did when it was brand new until the water runs clear and tastes wonderful

